

1:1250 SITE LOCATION PLAN

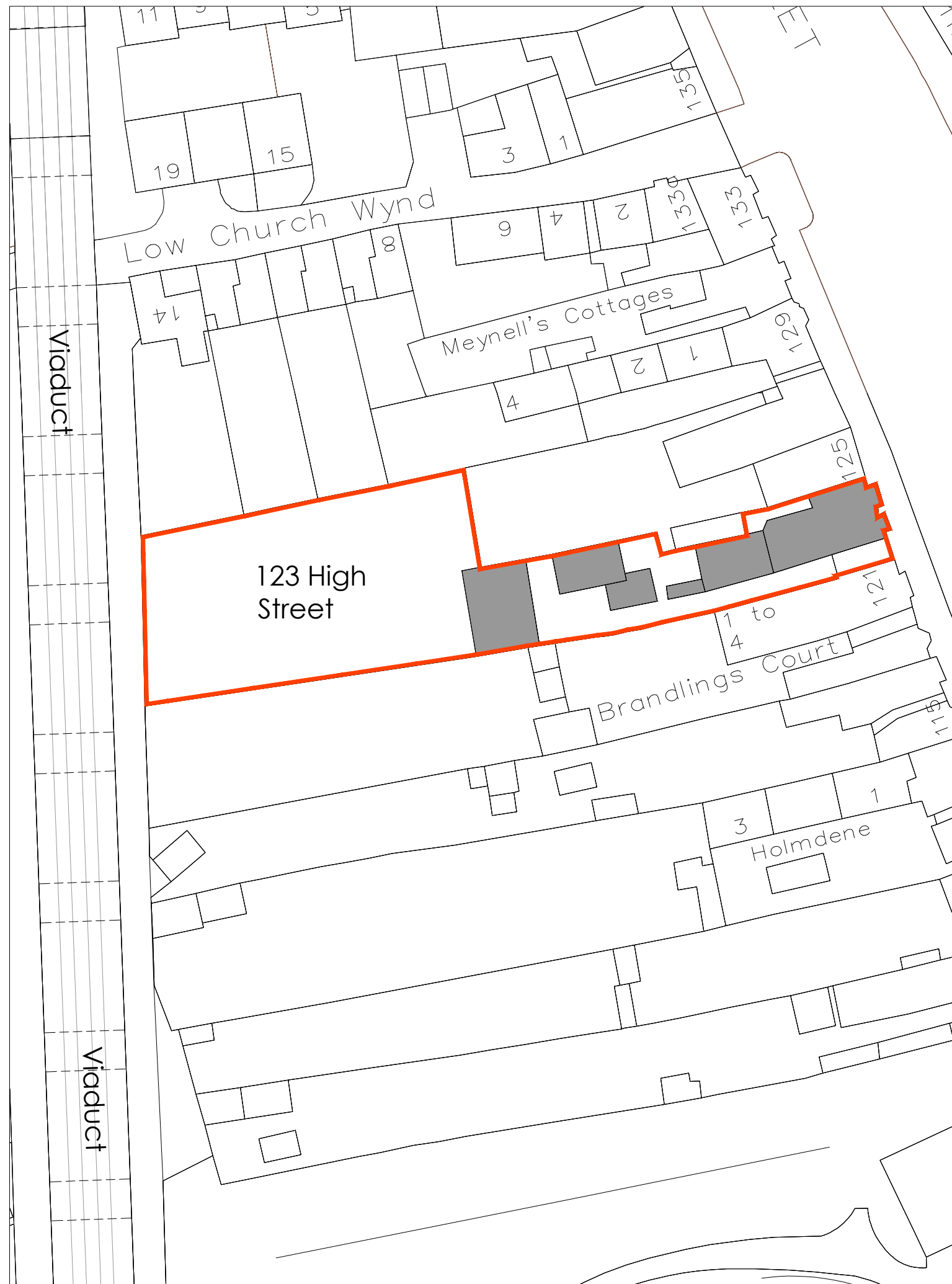
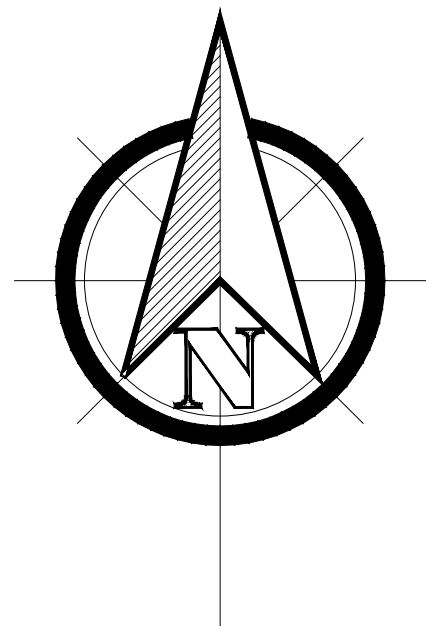

1:500 BLOCK PLAN

NOTES:

- DO NOT SCALE FROM THIS DRAWING.
- 1. This drawing is copyright of WardmanBrown. WardmanBrown is a trading name of Wardmans Architectural Services Limited.
- 2. All dimensions to be verified on site prior to any shop or site works being commenced.
- 3. Any discrepancies to be reported to the Designer BEFORE any work is put in hand.
- 4. This drawing must be read in conjunction with relevant consultants and specialists drawings.
- 5. This drawing must be read in conjunction with the drawings specified.

CDM 2015 - (Refer to Project Health & Safety Information)

HAZARDS

- 1. Live services adjacent/on site.
- 2. Excavations - Ground Collapse
- 3. Handling major components
- 4. Working at height - Falling
- 5. Machinery & Equipment
- 6. Ensure all blackwork has a minimum crushing strength of 3.5N/mm²
- 7. The weight of each block must not exceed 20kg

A Mar 20 Updated generally

REV DATE DETAILS

REVISIONS:

113 Stanhope Road South
Darlington, DL3 7SF
Tel: 01325 460227

info@wardmanbrown.com
www.wardmanbrown.com

CLIENT: Mr and Mrs Fox
PROJECT: 123 High Street Yarn
DRAWING TITLE: Site Location Plan & Block Plan
PURPOSE OF ISSUE: PLANNING
SCALE: 1:1250 & 1:500 @ A3
DATE: May 2019 DRAWN:LG DRG REVISION:
DRAWING NO: L018123-001 A